

**Specifications**

Nominal Voltage		12 V
Capacity (25°C)	10HR(10.8V)	120 Ah
	5HR(10.5V)	100Ah
	1HR(9.60V)	72Ah
Dimension	Length	406 ± 2mm (15.98inch)
	Width	173 ± 2mm (6.81inch)
	Height	208 ± 2mm (8.19inch)
	Total Height	238 ± 2mm (9.37inch)
Approx. Weight		34.6kg ± 2%
Terminal type		F13
Internal resistance (Fully charged, 25°C)		Approx. 4.5mΩ
Capacity affected by temperature (10HR)	40°C	102%
	25°C	100%
	0°C	85%
	-15°C	65%
Self-discharge (25°C)	3 month	Remaining Capacity: 91%
	6 month	Remaining Capacity: 82%
	12 month	Remaining Capacity: 65%
Nominal operating temperature		25°C ± 3°C (77°F ± 5°F)
Operating temperature range	Discharge	-15°C ~ 50°C (5°F ~ 122°F)
	Charge	-10°C ~ 50°C (14°F ~ 122°F)
	Storage	-20°C ~ 50°C (-4°F ~ 122°F)
Float charging voltage(25°C)		13.50 to 13.80V Temperature compensation: -18mV/°C
Cyclic charging voltage(25°C)		14.40 to 14.70V Temperature compensation: -30mV/°C
Maximum charging current		36A
Maximum discharge current		960A(5 sec.)
Designed floating life(20°C)		12 years

**Dimensions**

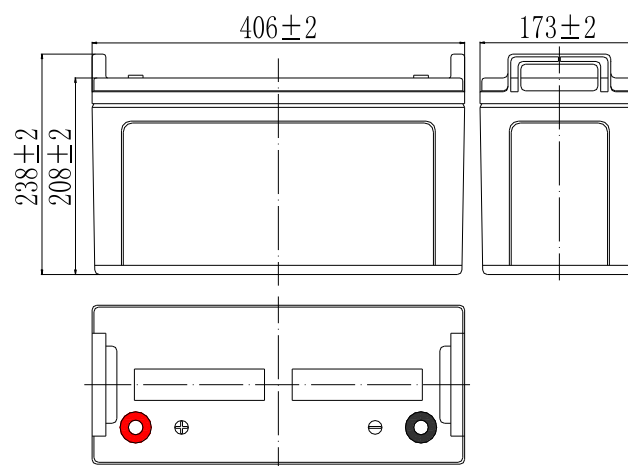

**Terminal**

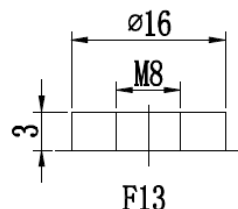

**Constant Current Discharge Characteristics (A, 25°C)**

F.V/TIME	10min	15min	30min	60min	2h	3h	4h	5h	8h	10h	20h
9.60V	228	190	115	72.0	43.8	31.0	24.5	20.8	14.7	12.2	6.47
9.90V	221	185	113	70.9	43.6	30.8	24.3	20.7	14.6	12.2	6.46
10.2V	212	178	110	69.1	43.2	30.6	24.2	20.5	14.5	12.2	6.44
10.5V	203	172	107	67.8	42.6	30.4	24.0	20.4	14.4	12.1	6.40
10.8V	192	163	103	65.7	41.5	29.4	23.3	19.8	14.0	12.0	6.36

**Constant Power Discharge Characteristics (Watt, 25°C)**

F.V/TIME	10min	15min	30min	60min	2h	3h	4h	5h	8h	10h	20h
9.60V	2462	2082	1295	821	508	364	288	246	174	146	77.7
9.90V	2389	2032	1269	808	505	362	286	245	173	146	77.5
10.2V	2290	1957	1230	788	500	360	284	243	172	145	77.3
10.5V	2192	1890	1201	772	493	357	282	241	171	144	76.9
10.8V	2068	1790	1157	749	480	346	274	234	166	143	76.3

Note: The above characteristics data can be obtained within three charge/discharge cycles.

**Construction**

Component	Positive plate	Negative plate	Container	Cover	Separator	Electrolyte	Safety valve	Terminal
Raw material	Lead dioxide	Lead	ABS	ABS	AGM	Gel	Rubber	Copper

## Discharge Characteristics(25°C)

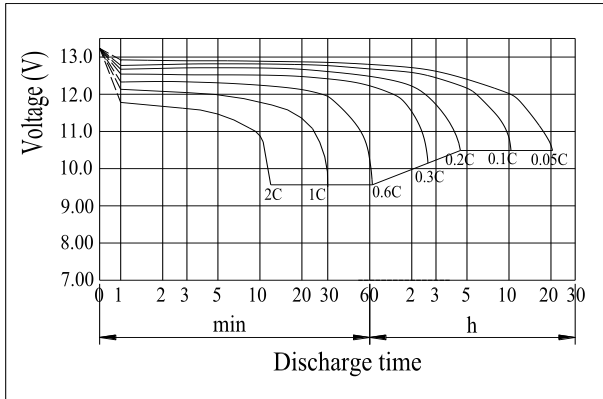

## Charging Characteristics(25°C)

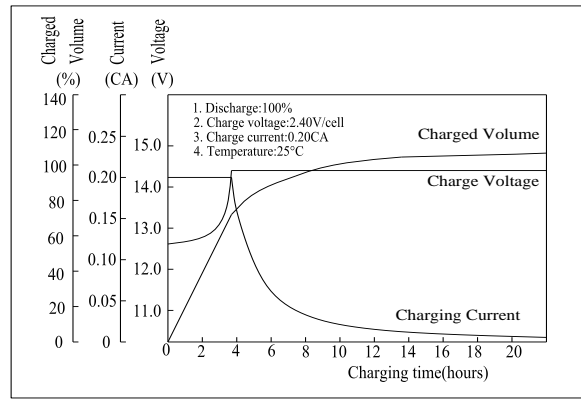

## The Relationship for Open Circuit Voltage and Residual Capacity (25°C)

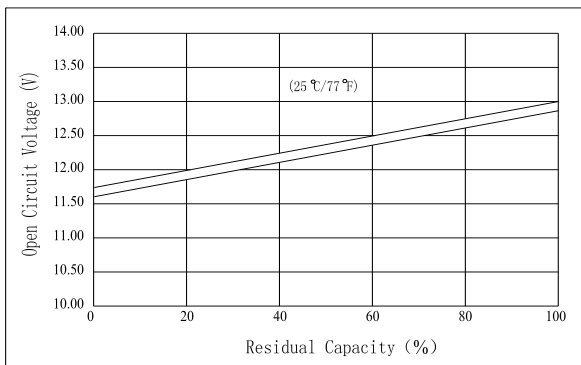

## The Relationship for Charging Voltage and Temperature

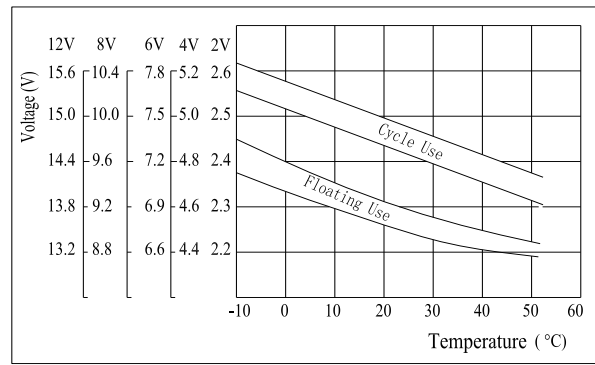

## Floating Life on Temperature

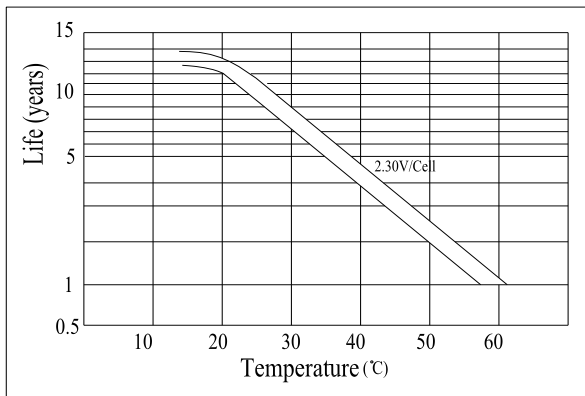

## Cycle Life on D.O.D(25°C)

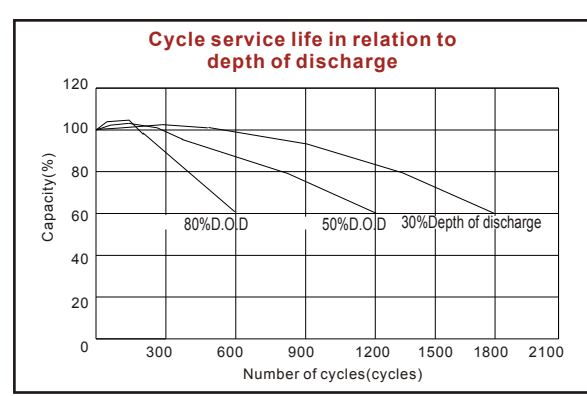

## Effect of Temperature on Capacity

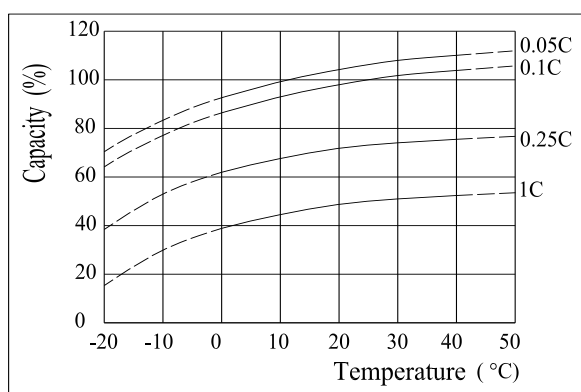

## Self-discharge Characteristics

